



## 3 Channel Irrigation Receiver

Add security and comfort to your lifestyle

- For use with standard irrigation solenoid valves.
- 3 Single contact relay outputs
- Independent Programmable timeout for each output:
  - 15, 30, 45 or 60 minutes
- Programmable with up to 24 different remote control channels
- 12V to 24V AC or DC supply input.
- Range 30 to 100m.



### SPECIFICATIONS

- Model EZE-IRRIG-103
- Supply voltage 12V-24V DC/AC
- Supply current 100mA Max
- Relay contact rating:
  - 3A Resistive Load
  - 700mA Inductive

<http://www.clickon.co.za>

### AUTOMATIC TIMEOUTS

The unit has built in independent automatic timeouts for each channel. The duration of these timeouts can be programmed for each channel. This setting is indicated by the LED flashing in the colour of the selected channel (Ch1=Red, Ch2=Green, Ch3=Amber)

- Automatic timeout = 15 minutes** (factory default)

1 Flash every 3 seconds



- Automatic timeout = 30 minutes**

2 Flashes every 3 seconds



- Automatic timeout = 45 minutes**

3 Flashes every 3 seconds

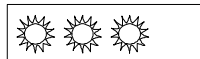

- Automatic timeout = 60 minutes**

4 Flashes every 3 seconds

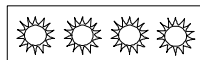

### INSTALLATION

- For optimal remote control range, keep Irrigation Receivers at least 500mm apart from one another or away from other ClickOn receiving devices.
- Always install the receiver in a location not directly subject to raindrops or excessive moisture.
- Program a ClickOn Remote Control or Wallmount Remote Control into each channel on the irrigation receiver.
- Typical application:

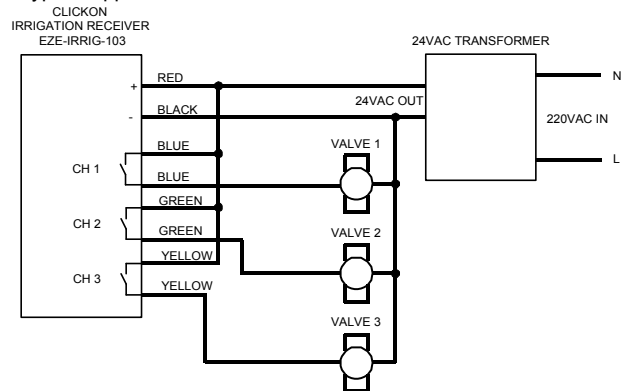

### WARRANTY

The manufacturer warrants that the product identified in this manual is free from defects in material or workmanship. This warranty is valid for a period of 12 months from date of purchase. The manufacturer, at its discretion, will repair or replace the defective product when returned to the manufacturer via the retailer of the system. In the event that no satisfaction can be obtained from the retailer of the system, only then can the manufacturer be approached directly by the final purchaser. The manufacturer shall not be responsible for any loss or damage of any nature whatsoever whether direct or indirect, consequential or otherwise, sustained as a result of the use of the product. Improper use or mishandling of this product by the purchaser will render this warranty null and void. No warranty claims will be entertained without presentation of a valid invoice. The manufacturer will charge the purchaser for services rendered outside the warranty period. Any implied warranties in respect of this product are expressly excluded. No agreement whether implied or referred are binding, unless agreed to in writing by the manufacturer.

EZE-IRRIG-103-R2 JUNE 2003 © 2003 ClickOn Technology (Pty) Ltd

### CHANNEL SELECTION

The colour of the LED indicates the current channel or relay contact selection:

RED: Channel 1 (Relay contact 1)

GREEN: Channel 2 (Relay contact 2)

AMBER: Channel 3 (Relay contact 2)

Press and release the MODE SELECT button on the irrigation receiver to select the next channel. The LED will stay on momentarily in the colour of the selected channel after which it will indicate the current mode of the selected channel (see MODES OF OPERATION)

Note: Operating a remote control that is programmed into the receiver, will result in the LED flashing rapidly for approximately 500ms in the colour of the channel for which the remote is programmed.

### TIMEOUT SELECTION

- Select the desired channel by pressing and releasing the MODE SELECT button until the LED colour indicates the selected channel (see CHANNEL SELECTION)
- Press and hold the MODE SELECT button.
- Do not release the button.**
- During this time, the LED stays on.
- After 4 seconds, the LED will start flashing, indicating that the program mode has been entered.
- Keep holding the button.**
- After another 4 seconds, the LED will start indicating the next timeout selection.
- Release the button.
- Repeat until the desired mode is selected.

## PROGRAMMING A REMOTE CONTROL DEVICE INTO THE IRRIGATION RECEIVER

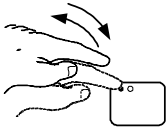

Press and release the button on the irrigation receiver to select the desired channel on the irrigation receiver (see CHANNEL SELECTION).

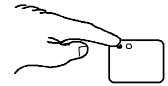

Place the irrigation receiver into the **programming mode** by pressing and holding the button on the irrigation receiver until the LED on the irrigation receiver starts flashing continuously. **Release the button.**

### FOR A 64 CHANNEL REMOTE CONTROL:

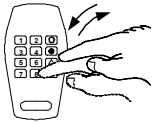

Select a channel of your choice on the remote control by pressing and releasing a channel key.



Press and hold the **ON** button on the remote control until the remote sounds **3 beeps** and the irrigation receiver LED flashes at a faster rate.



Release the remote control button and press and release the irrigation receiver button to exit the program mode.

### FOR A 16 CHANNEL REMOTE CONTROL:



Select a channel of your choice on the remote control by pressing and releasing a channel key.



Press and hold the **UP** button on the 16 channel remote control until the remote sounds **3 beeps** and the irrigation receiver LED flashes at a faster rate.



Release the remote control button and press and release the irrigation receiver button to exit the program mode.

### FOR A 6 CHANNEL REMOTE CONTROL:



Press and hold the **desired channel button** on the 6 channel remote control until the remote sounds **3 beeps** and irrigation receiver LED flashes at a faster rate.



Release the remote control button and press and release the irrigation receiver button to exit the program mode.

### FOR A WALLMOUNT REMOTE CONTROL:

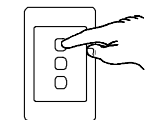

Press and hold the button on the wallmount remote control for 10 seconds. Check for a confirmation from the irrigation receiver (LED flashes at a faster rate).



Release the remote control button and press and release the irrigation receiver button to exit the program mode.

**NOTE:** The program mode on the irrigation receiver will automatically time out after 30 seconds if no programming commands are received.

## DELETING REMOTE CONTROL CHANNELS FROM THE IRRIGATION RECEIVER

The Irrigation Receiver can store up to 24 different remote control channels. If the irrigation receiver fails to program any new channels, one or more of the existing channels need to be deleted.

**Note:** To delete a single remote control channel from the irrigation receiver, the original remote control device must be used. To delete all remote control channels from the irrigation receiver, any remote control can be used.

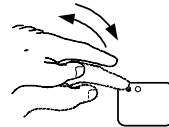

Press and release the button on the irrigation receiver to select the desired channel on the irrigation receiver (see CHANNEL SELECTION).

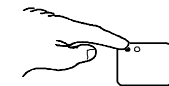

Place the irrigation receiver into the **programming mode** by pressing and holding the button on the irrigation receiver until the LED on the irrigation receiver starts flashing continuously. **Release the button.**

### FOR A 64 CHANNEL REMOTE CONTROL:



Select the channel to be deleted on the remote control.



Press and hold the **OFF** button on the remote control until the remote sounds **3 beeps** and the irrigation receiver LED flashes at a faster rate.



Release the remote control button and press and release the irrigation receiver button to exit the program mode.

### FOR A 16 CHANNEL REMOTE CONTROL:



Select the channel to be deleted on the remote control.



Press and hold the **DOWN** button on the remote control until the remote sounds **3 beeps** and the irrigation receiver LED flashes at a faster rate.



Release the remote control button and press and release the irrigation receiver button to exit the program mode.

### FOR A 6 CHANNEL REMOTE CONTROL:



Press and hold the **desired channel button** on the 6 channel remote control until the remote sounds **3 beeps**. **Keep holding** the remote control button until the remote sounds **another 4 beeps** and the the irrigation receiver LED flashes at a faster rate.



Release the remote control button and press and release the irrigation receiver button to exit the program mode.

### FOR A WALLMOUNT REMOTE CONTROL:

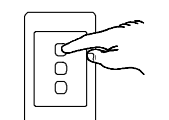

Press and hold the button on the wallmount remote control for 14 seconds. Check for a confirmation from the irrigation receiver (LED flashes at a faster rate).



Release the wallmount remote control button and press and release the irrigation receiver button to exit the program mode.

## **DELETING ALL CHANNELS FROM THE IRRIGATION RECEIVER USING A 6, 16 OR 64 CHANNEL REMOTE:**

Follow the steps for deleting a single channel but **keep holding the remote control button for another set of beeps**. Release the remote control button and press and release the irrigation receiver button to exit the program mode.

**NOTE:** The remote control channels for all three irrigation receiver channels will be deleted regardless of the irrigation receiver channel selection.